

# EXHIBITORS AREAS LAYOUT

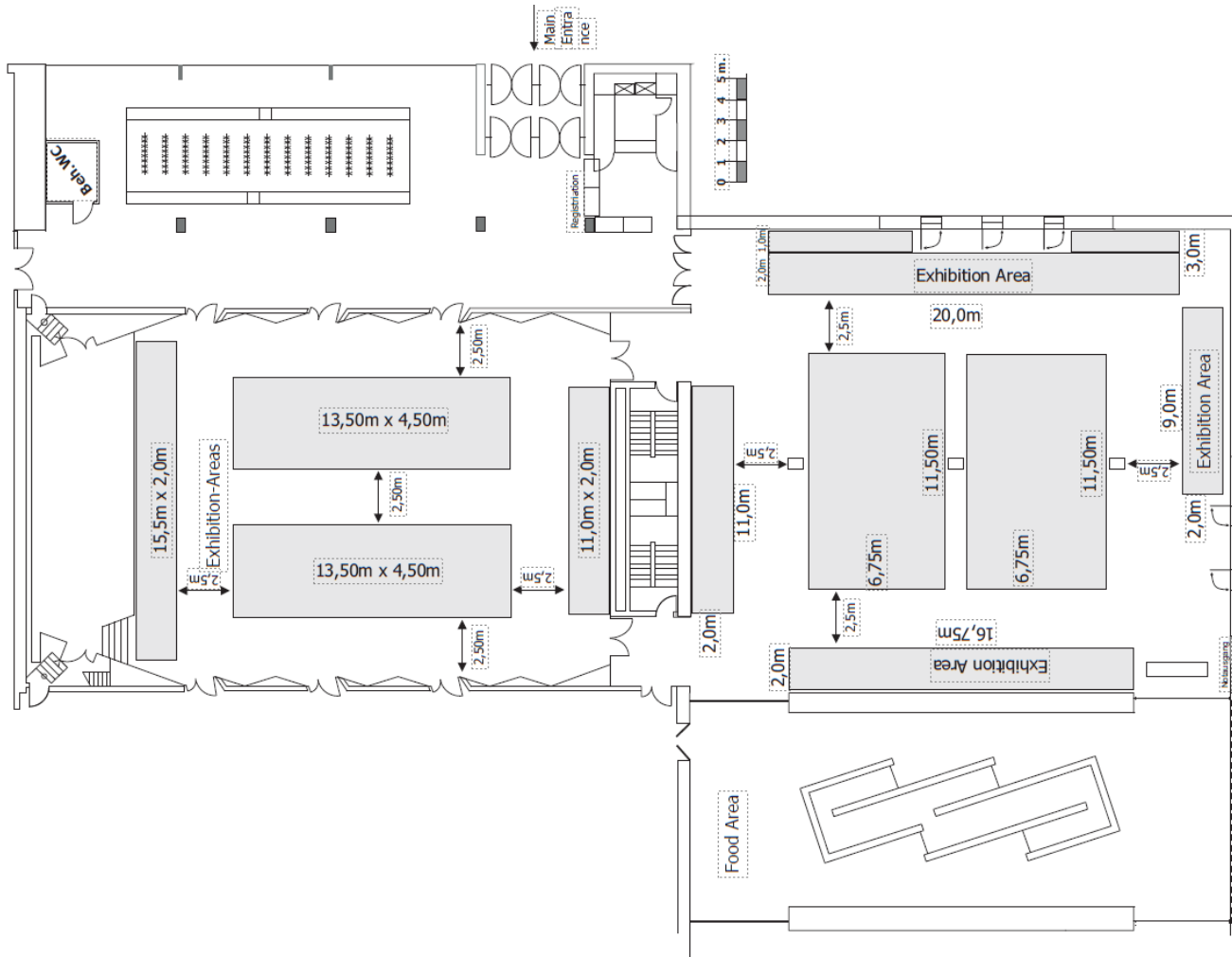

20<sup>th</sup> – 23<sup>rd</sup> of September 2026

**Exhibition**

**43<sup>rd</sup> International  
Telecommunications  
and Critical  
Infrastructure  
Energy Conference**  
Nürnberg, Germany



## KEY TOPICS:

### Power Conversion & Distribution

Rectifiers, inverters, HVDC  
Distribution, modular power systems

### Energy Storage & Batteries

Battery systems, lifecycle, safety,  
hybrid storage solutions

### Data Centers & Cloud

High-density power, cooling,  
efficiency, and reliability.

### Resilient Infrastructure & Safety

Codes, regulations, cybersecurity, AI  
support for power system recovery

### 5G/6G & Edge Infrastructure

Power for small cells, edge sites, and  
distributed architectures.

### Green Energy, e-Mobility

PV integration, microgrids, carbon  
reduction, smart grids, EV charging

## EXHIBITORS ADMISSION POLICY

**intelec**® exhibiting companies are required to meet the following criteria:

1) The company must be engaged in the design, development, manufacturing, marketing, distribution, operation or servicing of AC or DC power systems, energy conversion or energy storage equipment in communications networks or any other critical infrastructure as its principal business or maintain a department or division devoted to this work.

2) The company must offer products or services for sale directly to critical infrastructure or communications network integrators or operators.

Any exceptions to this policy will be reviewed by the Management Committee. The EXHIBITS-ONLY badges do not include attendance at the Technical Sessions of the conference.

Registration for the full Conference must be completed using the official registration form, which will be sent by mail or will be available on the website at [www.intelec2026.org](http://www.intelec2026.org).

Exhibit hours have been arranged to give exhibitors maximum exposure. Social functions have been planned in the exhibit area so that delegates meet on both a social and business level. All session coffee breaks will be held in the Exhibit Hall's food service areas.

Conference Location

**Meistersingerhalle Nürnberg**



## SPACE COST PER m<sup>2</sup>

Prices +19% VAT

Before May 1, 2026 ..... 400.00 EUR

After May 1, 2026 ..... 470.00 EUR

### Space cost includes:

- Rental of space including power socket
- General announcement on website and conference proceedings
- Watchman service
- One table and two chairs (on request)
- Conference proceedings
- Two free conference badges, more on request
- Two free conference dinner tickets
- Refreshments and lunch

## EXHIBIT HOURS (APPROXIMATE)

Monday, Sept. 21 <sup>st</sup>	11:30 am – 6:30 pm
Tuesday, Sept 22 <sup>nd</sup>	09:00 am – 6:30 pm
Wednesday, Sept 23 <sup>rd</sup>	10:00 am – 6:30 pm

Exhibit hours may change slightly after the technical program schedule is complete. Please check the exhibit schedule in the Program Booklet provided at the start of the conference for any change in exhibit times.

## BOOTH RESERVATION

To secure exhibition space email to:  
[exhibition@intelec2026.org](mailto:exhibition@intelec2026.org)